



SURVEYOR'S OFFICE

Hamilton County

Kenton C. Ward, Surveyor

Phone (317) 776-8495

Fax (317) 776-9628

Suite 188

One Hamilton County Square

Noblesville, Indiana 46060-2230

December 8, 2005

To: Hamilton County Drainage Board

Re: Willowview Road Drain, Noblefield Business Park Arm

Attached is a petition filed by Chris Potee along with a non-enforcement request, plans, calculations, quantity summary and assessment roll for the Willowview Road Drain, Noblefield Business Park Arm to be located in Noblesville Township. I have reviewed the submittals and petition and have found each to be in proper form.

I have made a personal inspection of the land described in the petition. Upon doing so, I believe that the drain is practicable, will improve the public health, benefit a public highway and be of public utility and that the costs, damages and expenses of the proposed drain will probably be less than the benefits accruing to the owners of land likely to be benefited. The drain will consist of the following:

12" RCP	45 ft	21" RCP	242 ft
18" RCP	924 ft	Open Ditch	1,419 ft

The total length of the drain will be 2,630 feet.

The detention basins located in Noblefield Business Park are not to be considered part of the regulated drain. However, the concrete swales within the detention areas will be maintained as part of the regulated drain as open ditch. The maintenance of the detention basins will be the responsibility of the Owners Association. The Board will however retain jurisdiction for ensuring the storage volume for which the detention basins were designed will be retained, thereby, allowing no fill or easement encroachments.

Upon review of the drainage shed, there will not be a change in the current assessment with this proposal.

The petitioner has not submitted surety for the proposed drain. The drainage facilities are constructed and should be considered acceptable as constructed.

Parcels assessed for this drain may be assessed for the Sly Run Drain at sometime in the future.

I believe that this drain meets the requirements for Urban Drain Classification as set out in IC 36-9-27-67 to 69. Therefore, this drain shall be designated as an Urban Drain.

I recommend that upon approval of the above proposed drain that the Board also approve the attached non-enforcement request. The request is for the reduction of the regulated drain easement to those easement widths as shown on the secondary plats for Noblefield Business Park as recorded in the office of the Hamilton County Recorder.

The regulated drain easement across parcel 10-10-03-00-00-005.000 owned by Carter Lumber and 10-10-03-00-00-005.001 owned by Noblefield Development II will be the statutory easement of 75' per half as set out under IC 36-9-27-33. The regulated drain easement across parcels 10-10-03-02-01-009.000 and 10-10-03-02-01-008.000, Park 32 West lots 9 and 8 respectively, both owned by Frederick E. Parker III Family Limited Partnership, will be the existing 40' drainage & utility easement (D&UE) as shown on the plat for Park 32 West, as recorded in the office of the Hamilton County Recorder.

I recommend the Board set a hearing for this proposed drain for March 27, 2005.

Sincerely,

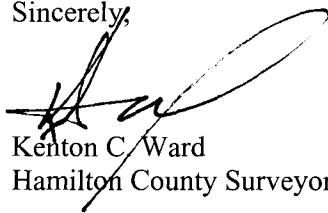
A handwritten signature in black ink, appearing to read 'Kenton C. Ward', is written over a horizontal line. The signature is fluid and cursive.

Kenton C. Ward
Hamilton County Surveyor

KCW/llm

The Petitioner further requests that the Drain be classified as an Urban Drain as per IC 36-9-27-69(d).

RECORDED OWNER(S) OF LAND INVOLVED

SIGNED _____

Chris Pojce
PRINTED NAME _____

12-28-04
DATE _____

SIGNED _____

PRINTED NAME _____

DATE _____

SIGNED _____

PRINTED NAME _____

DATE _____

SIGNED _____

PRINTED NAME _____

DATE _____

BEFORE THE HAMILTON COUNTY DRAINAGE BOARD
IN THE MATTER OF

Willowview Road Drain, Noblefield Business Park Arm

NOTICE

To Whom It May Concern and: Sid Webb LLC

Notice is hereby given of the hearing of the Hamilton County Drainage Board on the **Willowview Road Drain, Noblefield Business Park Arm** on **March 27, 2006** at **9:15 A.M.** in Commissioners Court, Hamilton County Judicial Center, One Hamilton County Square, Noblesville, Indiana, and which construction and maintenance reports of the Surveyor and the Schedule of Assessments made by the Drainage Board have been filed and are available for public inspection in the office of the Hamilton County Surveyor.

Hamilton County Drainage Board

Attest: Lynette Mosbaugh

ONE TIME ONLY

BEFORE THE HAMILTON COUNTY DRAINAGE BOARD
IN THE MATTER OF THE

Willowview Road Drain, Noblefield Business Park Arm

NOTICE

Notice is hereby given pursuant to Section 405 of the 1965 Indiana Drainage Code that this Board, prior to final adjournment on **March 27, 2006** has issued an order adopting the Schedule of Assessments, filed the same and made public announcement thereof at the hearing and ordered publication. If judicial review of the findings and order of the Board is not requested pursuant to Article Eight of this code within twenty (20) days from the date of this publication, the order shall be conclusive.

Hamilton County Drainage Board

Attest: Lynette Mosbaugh

ONE TIME ONLY

OFFICE OF
HAMILTON COUNTY DRAINAGE BOARD

Notice of Hearing on Reconstruction & Schedule of Assessments and Damages on the
Willowview Road Drain, Noblefield Business Park Arm.

Sid Web LLC
559 Mill Farm Rd.
Noblesville, IN 46062

The reconstruction report of the Surveyor and schedule of damages and benefits as determined by the Drainage Board for the proposed improvement known as **Willowview Road Drain, Noblefield Business Park Arm** have been filed and are available for inspection in the office of the County Surveyor. The schedule of assessments shows the following lands in your name are affected as follows:

Description of Land	Acres Benefited	Damages	Reconst. Assmt.	% of Total	Maint. Assmt.
10-10-03-00-00-004.101					
S3 T18 R4 3.00 Ac	3.00	Zero	*	*	*
*No cost for construction. No change in current maintenance assessment rates.					

The hearing on the Surveyor's reconstruction report and on the schedules of damages and assessments are set for hearing at **9:15 A.M. on March 27, 2006**, in the Commissioner's Court. The law provides the objects must be written and filed not less than 5 days before the date of the hearing. Objections may be for causes as specified by law and which are available at the Surveyor's Office. Written evidence in support of objections may be filed. The failure to file objections constitutes a waiver of your right to thereafter object, either before the Board or in court on such causes, to any final action of the Board. On or before the day of the hearing before the Board, the Surveyor shall and any owner of affected lands may cause written evidence to be filed in support of or in rebuttal to any filed objections.

HAMILTON COUNTY DRAINAGE BOARD
One Hamilton County Square, Ste. 188
Noblesville, IN 46060-2230

This drain shall be designated as an Urban Drain.

See enclosed letter for easement information.

FINDINGS AND ORDER

CONCERNING THE MAINTENANCE OF THE

Willowview Road Drain, Noblefield Business Park Arm

On this **27th day of March 2006**, the Hamilton County Drainage Board has held a hearing on the Maintenance Report and Schedule of Assessments of the **Willowfield Road Drain, Noblefield Business Park Arm**.

Evidence has been heard. Objections were presented and considered. The Board then adopted the original/amended Schedule of Assessments. The Board now finds that the annual maintenance assessment will be less than the benefits to the landowners and issues this order declaring that this Maintenance Fund be established.

HAMILTON COUNTY DRAINAGE BOARD

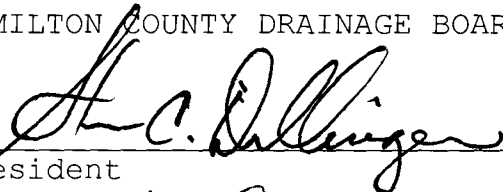

President



Member /



Member

Attest: 

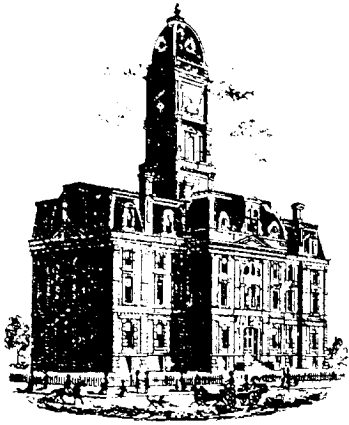

SURVEYOR'S OFFICE

Hamilton County

Kenton C. Ward, CFM
 Surveyor of Hamilton County
 Phone (317) 776-8495
 Fax (317) 776-9628

Suite 188
 One Hamilton County Square
 Noblesville, Indiana 46060-2230

To: Hamilton County Drainage Board

March 13, 2008

Re: Willowview Road Drain: Noblefield Business Park Arm

Attached are as-builts, certificate of completion & compliance, and other information for Noblefield Business Park Arm. An inspection of the drainage facilities for this section has been made and the facilities were found to be complete and acceptable.

During construction, changes were made to the drain, which will alter the plans submitted with my report for this drain-dated December 8, 2005. The report was approved by the Board at the hearing held March 27, 2006. (See Drainage Board Minutes Book 9, Pages 130-131)

The changes are as follows:

Structure:	Length:	Size	Material:	Up Invert:	Dn Invert	Grade:
4-3	157	24	RCP	791.42	790.58	0.5
15-14	29	12	RCP	791.43	791.24	0.7
14-13	14	18	RCP	791.24	791.21	0.2
13-12	63	18	RCP	791.21	790.65	0.9
16-13	300	18	RCP	794.59	791.21	1.1
18-17	29	18	RCP	794.99	794.96	0.1
17-16	15	18	RCP	794.96	794.59	2.5
9-8	121	18	RCP	795.19	794.7	0.4
8-7	56	21	RCP	794.7	794.38	0.6
11-10	32	21	RCP	794.72	794.41	1
24-23	168	21	RCP	793.62	789.11	2.7
23-22	47	21	RCP	789.11	788.64	1
6-5	154	15	RCP	791.55	790.55	0.6
2-1	36	18	RCP	788.45	787.94	1.4
21-20	44	21	RCP	788.55	788.33	0.5

RCP Pipe Totals:

12	29
15	154
18	578
21	347
24	157

Total: 1265

The length of the drain due to the changes described above is now **1265 feet**.

The non-enforcement was approved by the Board at its meeting on March 27, 2006 and recorded under instrument #200600019142. Sureties were not obtained for this project.

I recommend the Board approve the drain's construction as complete and acceptable.

Sincerely,

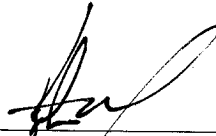

Kenton C. Ward, CFM
Hamilton County Surveyor

KCW/slm



PLAN VIEW

SCALE 1" = 50'

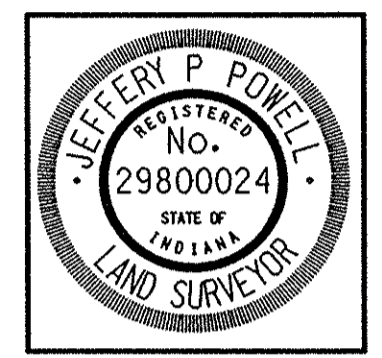

Jeffery P. Powell L.S.

Noblefield As-Built

Date: 04-07-2005

This information was gathered for input into the Hamilton County Geographic Information System (GIS). This document is considered an official record of the GIS.

Entry Date: 3-13-05

Entered By: SLN

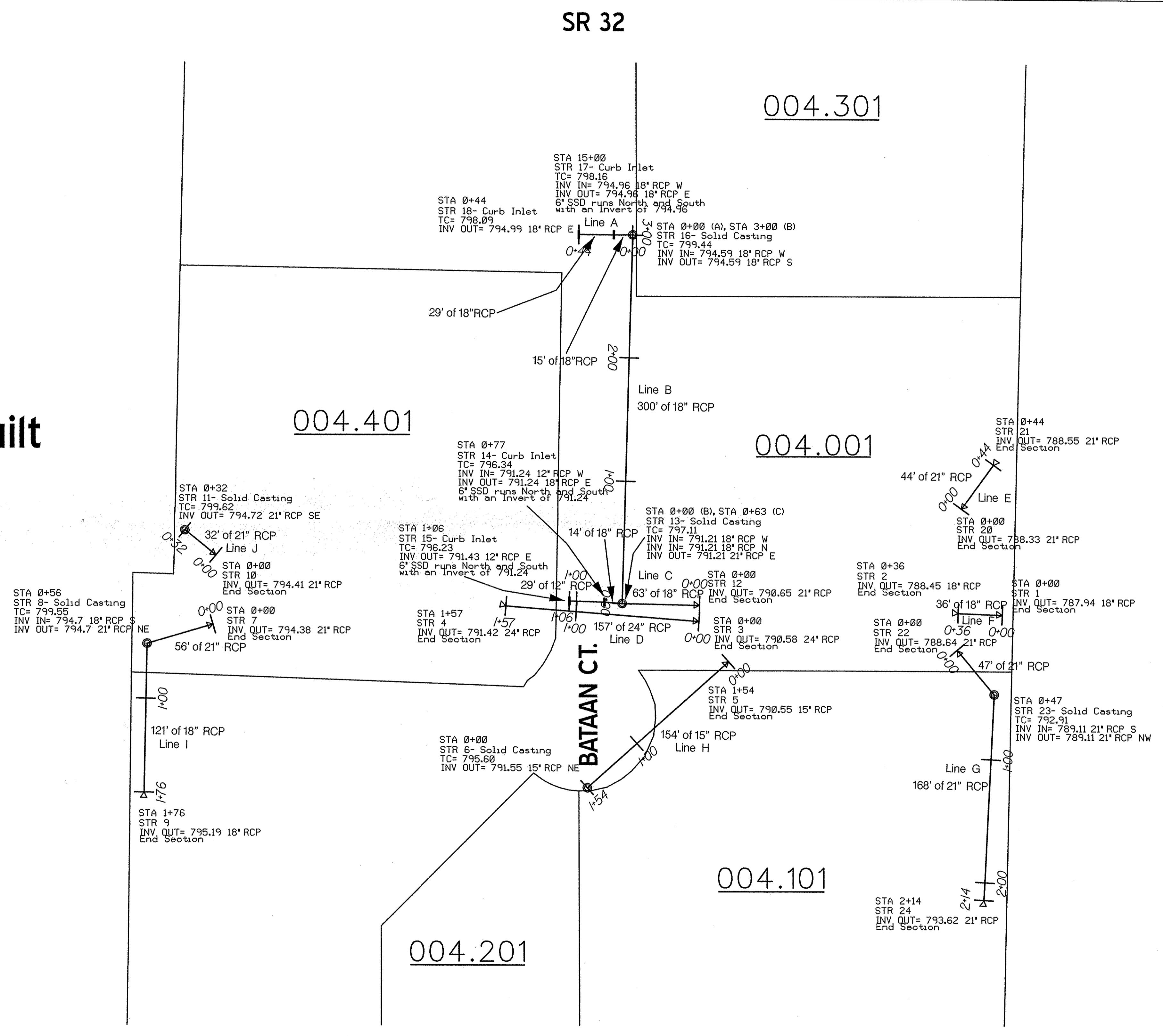

PROFILE VIEW

HORIZONTAL SCALE 1" = 50'

VERTICAL SCALE 1" = 5'

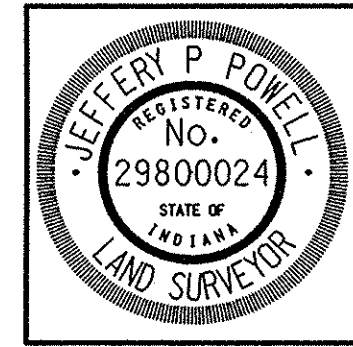

Jeffery P. Powell L.S.

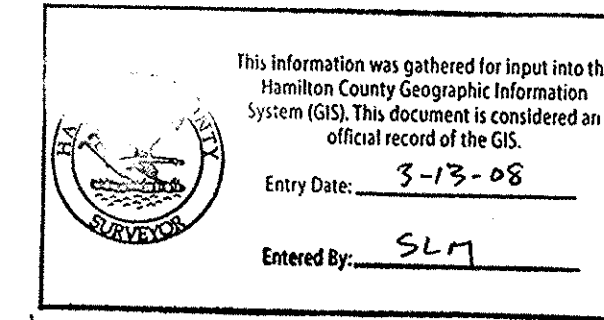
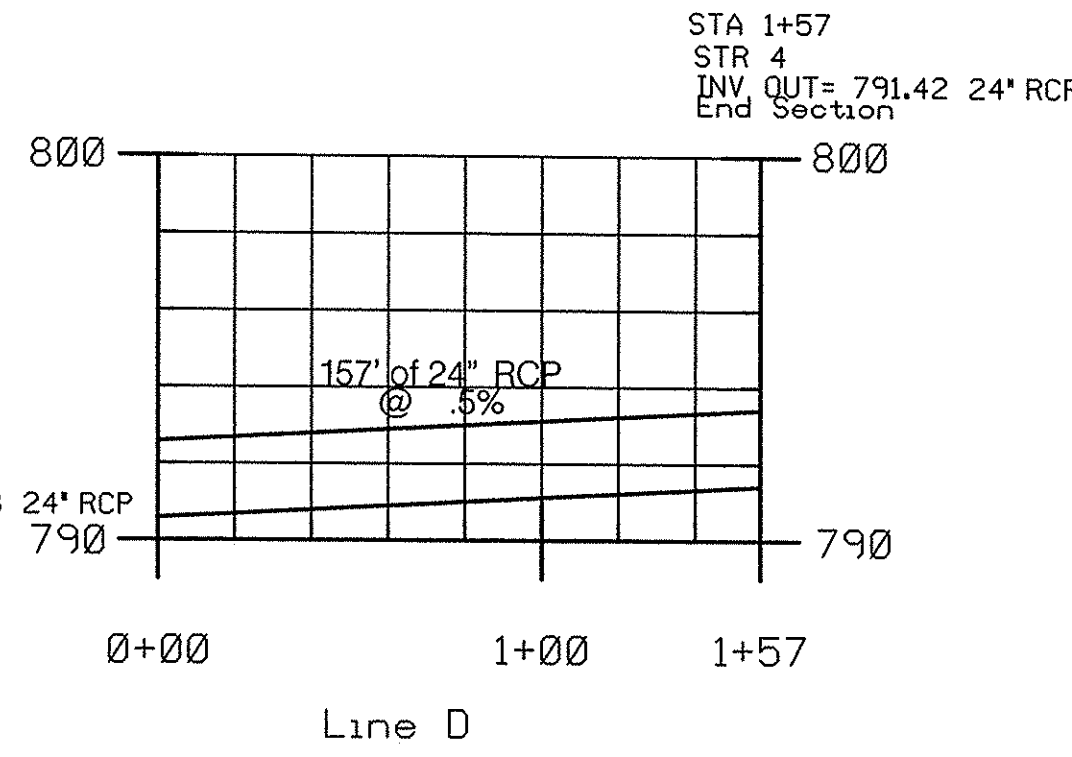
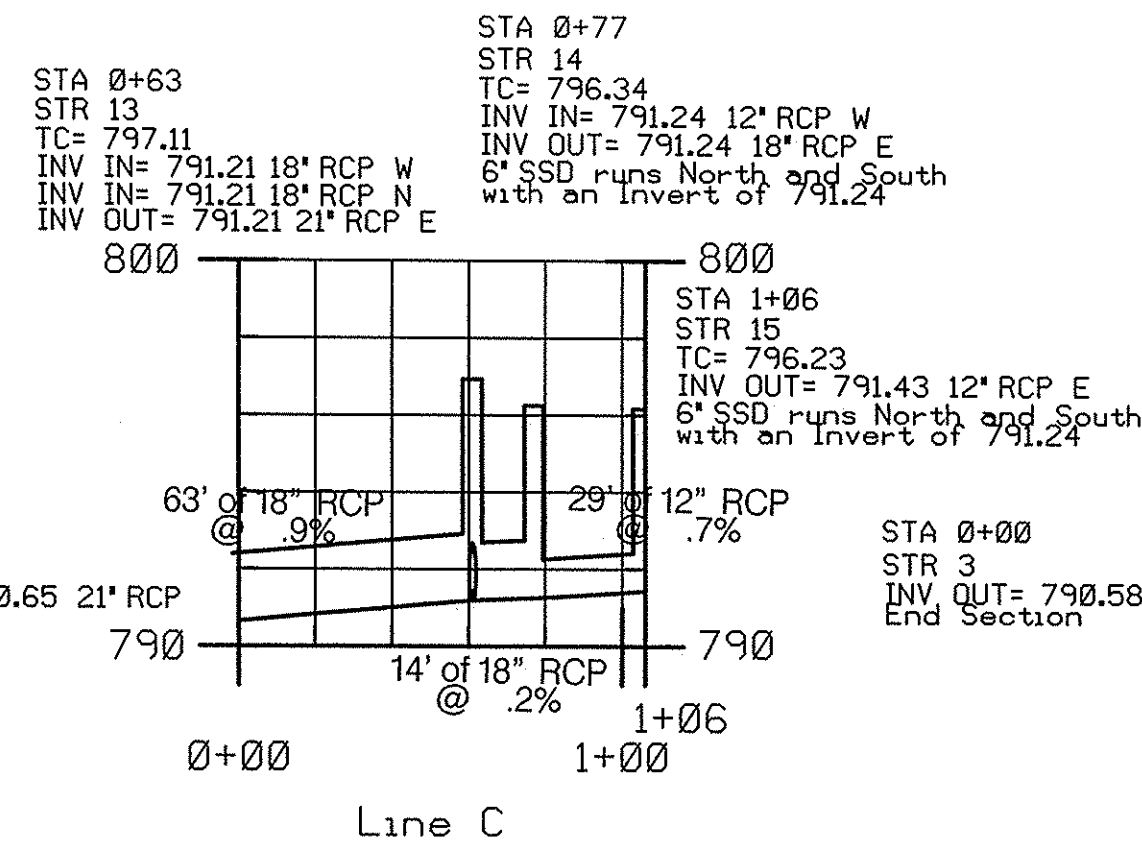
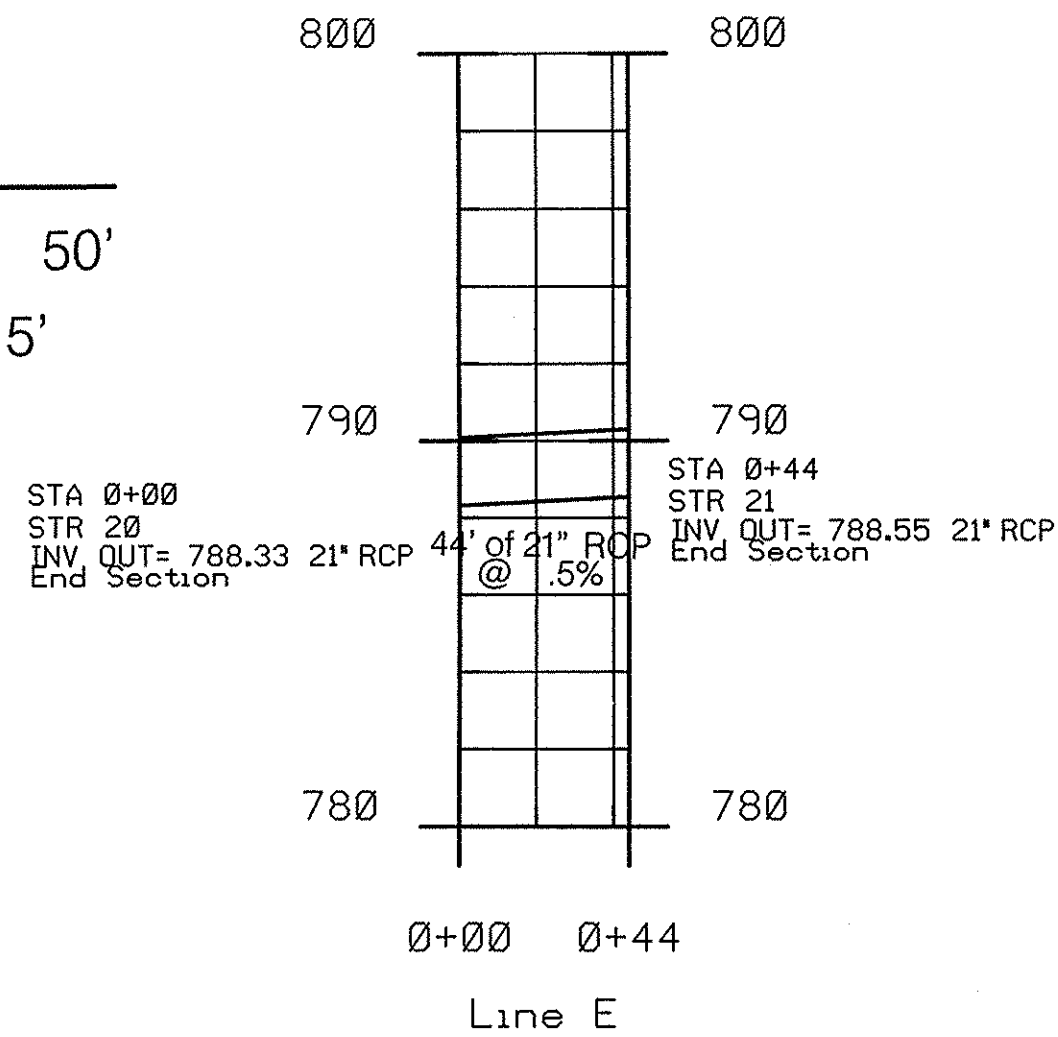

Noblefield As-Built

Date: 04-07-2005

